

Ordering Code: **ML-21A4-X-Y 01-Z**

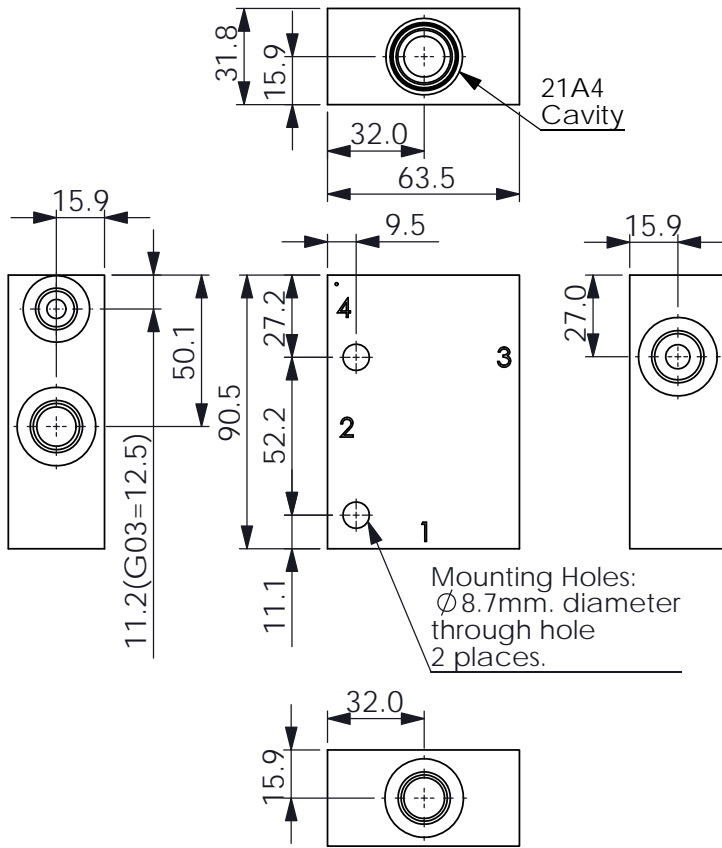

UNIT:mm

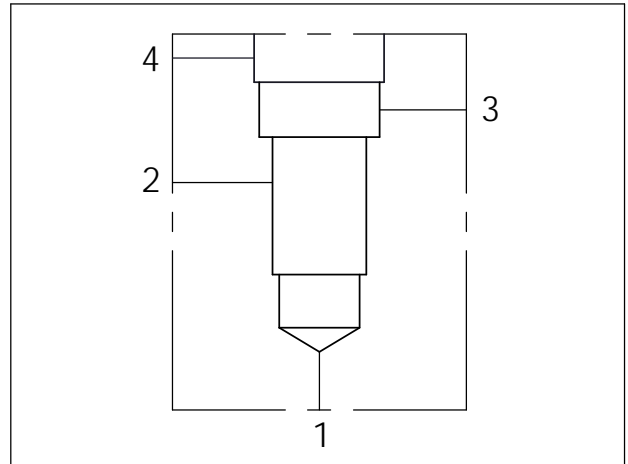
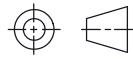

### TECHNICAL DATA

Aluminum Body Pressure Rating: 210 bar  
Ductile Iron Body Pressure Rating: 350 bar

Cavity:

Refer to 21A4

\* Refer to Winner Cartridge Valves Catalog.

Aluminum	0.38 kg(WITHOUT VALVES)
Ductile Iron	1.02 kg(WITHOUT VALVES)

\* If you need the special specification. Please contact us.

### PORT SIZE

X	PORTS	PORT	PORT	
	1,2	3	4	
<b>G03</b>	G 3/8"	G 3/8"	G 3/8"	
<b>G03A</b>	G 3/8"	G 3/8"	G 1/4"	
<b>P03</b>	3/8"PT	3/8"PT	3/8"PT	
<b>S06</b>	SAE 6	SAE 6	SAE 6	

### Y BODY MATERIAL

**A** HIGH-STRENGTH ALUMINUM

**S** DUCTILE IRON

### Z CARTRIDGE VALVES SELECTION

WITHOUT VALVE

**PV0A** PV21A40AL (40LPM,7-210bar)

The selection is only example. Please refer to Winner Cartridge Program and to select the appropriate valves and manifolds assembly in accordance with request function (flow 、 pressure 、 ... etc.)